

drylin[®] linear technology – drylin[®] N low-profile linear guides



Low profile and lightweight

Lubrication-free **dry-tech**[®] sliding elements

Anodised aluminium rail

High speed and acceleration possible

Quiet operation

drylin® N low-profile linear guides | Advantages

Lightweight, maintenance-free, corrosion-resistant and low wear

Lubrication-free low-profile linear guides – drylin® N

The low-profile range drylin® N offers extremely low profiles in several widths. Like all drylin® products the carriages run without lubrication in an anodised aluminium profile. The selected materials and the unique design make drylin® N a cost-effective and flexible guide system.

- Low profile between 6 and 12mm
- Lightweight
- Many carriage options – also with pre-load
- Maintenance-free dry operation
- Corrosion-free
- Low wear with low coefficient of friction
- Silver or black-anodised rails

Typical application areas

- Agricultural machinery
- Automotive
- Medical technology
- Facade construction
- Packaging industry

 **Available from stock**
Detailed information about delivery time online.

 **Price breaks online**
No minimum order value. No minimum order quantity.

 **Max. +90°C**
(+50°C for overmoulded sliding elements)
Min. -40°C

 **17mm – 80mm**

 **Service life calculation**
► www.igus.eu/drylin-expert



Free from toxins
2011/65/EU (RoHS)
ESD-compatible
(electrostatic discharge)



Cleanroom certified
IPA Fraunhofer

drylin® N low-profile linear guides | Product overview

Numerous options in four different widths and small installation heights



Guide rails

- Four installation sizes: 17, 27, 40 and 80mm
- Low profile, lightweight design
- Clear anodised (silver) or black anodised surfaces

► From page 977



Guide carriage – installation size 17

- Solid plastic made from high-performance polymer iglidur® J
- Compact for the smallest installation spaces
- Length of carriage up to 40mm

► Page 977



Guide carriage – installation size 27

- Carriage with changeable sliding elements
- Sliding carriages with captive overmoulded sliding elements
- Variable lengths and screw on options

► Page 979



Guide carriage – installation size 40

- Carriage with thread pin or plain hole
- Pre-load version available

► Page 981



Guide carriage – installation size 80

- Carriage with wide load-bearing surface
- Lubrication-free due to high-performance polymers iglidur® J/J200
- Low profile design due to threaded holes

► Page 983



Telescopic system

- Continuous lengths up to 1,200mm (total extension)
- Available with partial, total or over extension
- With locking mechanism if required

► Page 988



Pre-load prism slides

- Easy positioning of carriage
- Four pre-load classes
- Guaranteed drive force and holding force
- Extremely lightweight low-profile

► From page 984



Based on drylin® N

drylin® SLN miniature linear module
► from page 1339



The most important decision criterion for drylin® N low-profile linear guides is the low installation height as this makes it possible to achieve a maximum load.

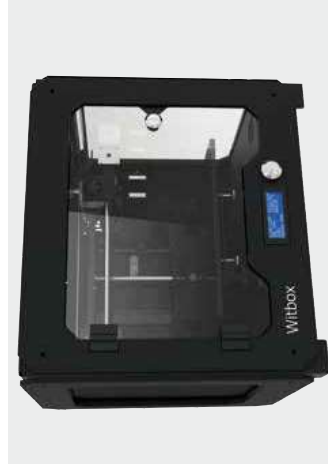

drylin® N low-profile linear guides and drylin® SD lead screw drives perform the height adjustments. As a black-anodised profile, drylin® N blends into the design of the 3D printer.



In the redesigning of the table guidance for this automated teller, the focus was on a ready-to-install, cost-effective, durable and lubrication-free bearing and system.



The quiet, lubrication-free, low-profile design of drylin® N made it the ideal solution and enabled it to fulfil all relevant safety requirements. The rails could be connected to the desired length.



The removal unit is moved along the X-Y axis using the space-saving and cost-saving drylin® N low-profile linear guide. The robust drylin® T guide system undertakes the vertical guidance.



The sampling device uses drylin® linear plain bearings to remove the products precisely and smoothly.

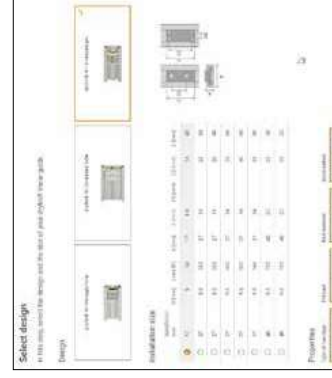

Expert for linear guides: System selection & service life calculation with CAD
Configure and calculate the service life of linear bearings – constantly expanded by new sizes and products

Easily calculate the service life of your required linear guide and configure with a few clicks. Select a drylin® system and add the relevant environmental parameters. Select the bearing size, carriage, number and position. Then enter the distance between the rails and the mounting. Define more relevant parameter of the guidance and select a rail length. The results are displayed.

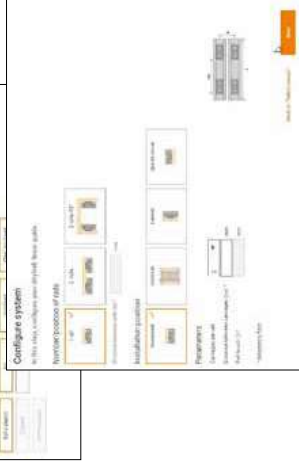

 www.igus.eu/drylin-expert



Download the online tool app now



drylin® CAD configurator: Generate complete 3D models for drylin® linear technology according to your specifications

The igus® CAD online configurator gives you the ability to design and save your linear guide as a system, individual components directly as a 3D model in all commonly used formats, or to have these sent by e-mail – free of charge and without registration.



www.igus.eu/drylin-CAD

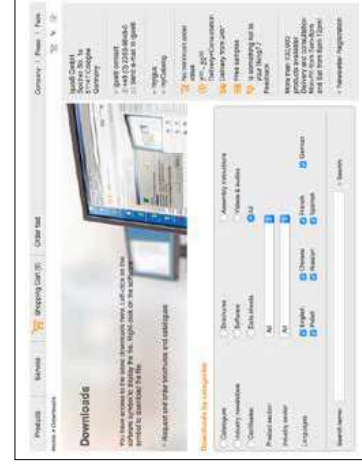

More information about the products can be found in the igus® download area

- Assembly instructions
- Assembly videos
- System design
- Catalogues



www.igus.eu/downloads



Floating bearing	NW-17	NW-27	NW-40	NW-80
LLY	0.6	0.45	0.4	0.6
LLZ	0.5	0.8	0.8	0.8
LLYZ	Y: 0.6 Y: 0.5	Y: 0.3 Y: 0.4	Y: 0.4 Y: 0.8	Y: 0.6 Y: 0.8



Technical details on floating bearings ► Page 907
The 2:1 Rule ► Page 907

Technical options for drylin® low-profile linear guides

Clip-on sliding elements

Depending on the installation size, up to three lubrication-free sliding elements made from the high-performance polymer iglidur® J are clipped on around the zinc die-casting carriage body. These can be changed any time simply and fast, the zinc die-casting carriage can be reused. A set of appropriate sliding elements is available for every clip-on carriage (Part No. NEK... ► Page 992).

Pre-load function

The use of sliding elements with an integrated spring pre-load function prevents the carriages in the rail profile from rattling. Adjustment occurs silently using the pre-load principle, making the guide suitable for use in noise-sensitive environments such as the automotive, medical or furniture sectors. Pre-load increases the displacement force by max. 10N.

Overmoulded sliding elements

With this carriage type, the zinc die-casting body is made as an integral part of the high-performance polymer iglidur® J/ J200 during the injection moulding process. For the user this production process offers the advantage, that the sliding surface is connected captive and insolubly to the carriage. This makes it quicker to install the carriages in the profile. Robust storage is possible, including in the form of bulk goods, as the sliding elements cannot come loose. It is not possible to retrofit sliding elements; the carriages must be entirely replaced at the end of their service life. The continuous operating temperature for overmoulded sliding elements is +50°C.

Tightening torque for drylin® connections between metal parts

Metric thread (Da)	Tightening torque [Nm]	Recommended tightening torque [Nm]
M3	0.5 – 1.1	0.7
M4	1.0 – 2.8	1.5
M5	2.0 – 5.5	3.0
M6	4.0 – 10.0	6.0
M8	8.0 – 23.0	15.0
M10	22.0 – 46.0	30.0

Please be aware of the minimal screw-in depth for aluminium and zinc die-casting parts: 1.5 x Da

System selection

System	N17	N27	N40	N80
Rail width	17mm	27mm	40mm	80mm
Installation height	6mm	9.5mm	9.5mm	12mm

General properties	
Rail weight	150g/m
Carriage weight	1.7g
Max. rail length	2,000mm
Load capacity, static	
Fy	50N
Fz	50N
Mx	0.31Nm
My, Mz	0.18Nm

Load capacity, static

Fy	50N	500N	700N	1,000N
Fz	50N	500N	700N	1,000N
Mx	0.31Nm	5Nm	10Nm	32.4Nm
My, Mz	0.18Nm	2.5Nm	6Nm	15Nm

Carriage options

Floating bearing in y-direction	●	●	●	●
Floating bearing in z-direction	●	●	●	●
Floating bearing in yz-direction	●	●	●	●
Pre-load (1N)	●	●	●	–
Overmoulded version	–	●	●	●
Carriage with through hole	–	●	●	–
Carriage with threaded pin	●	●	●	–
Carriage with threaded hole	–	–	–	●

Table 01: System selection ● available – not available

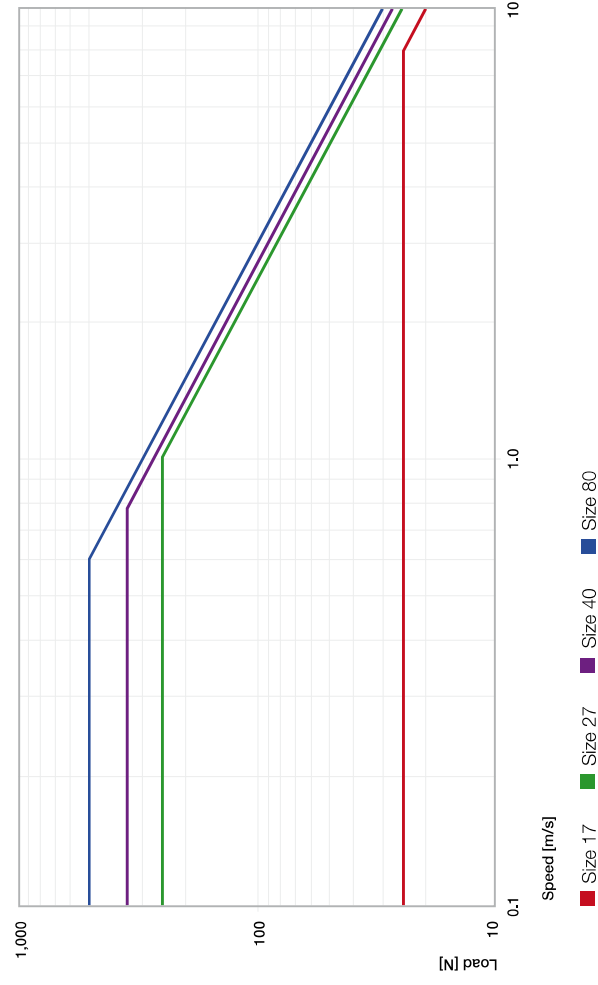

Diagram 01: F v diagram, maximum permissible dynamic load



Complete system



Order key

Type	Installation size	Options
NW - 22 - 17 - 30 - LLY		Options: Type of carriage: 02: Carriage with threaded pin; 22: Double carriage with threaded pin
	Guide carriages	Options: P: Pre-load Floating bearing: LLY: y-direction (not possible with the "P" version) LLZ: z-direction LLYZ: yz-direction
	Type of carriage	Options: P: Pre-load Floating bearing: LLY: y-direction (not possible with the "P" version) LLZ: z-direction LLYZ: yz-direction
	Rail width	Options: P: Pre-load Floating bearing: LLY: y-direction (not possible with the "P" version) LLZ: z-direction LLYZ: yz-direction
	Carriage length	Options: P: Pre-load Floating bearing: LLY: y-direction (not possible with the "P" version) LLZ: z-direction LLYZ: yz-direction
	Options	Options: P: Pre-load Floating bearing: LLY: y-direction (not possible with the "P" version) LLZ: z-direction LLYZ: yz-direction

Order key

Type of carriage:
02: Carriage with threaded pin;
22: Double carriage with threaded pin

Options:
P: Pre-load
Floating bearing:
LLY: y-direction
(not possible with the "P" version)
LLZ: z-direction
LLYZ: yz-direction

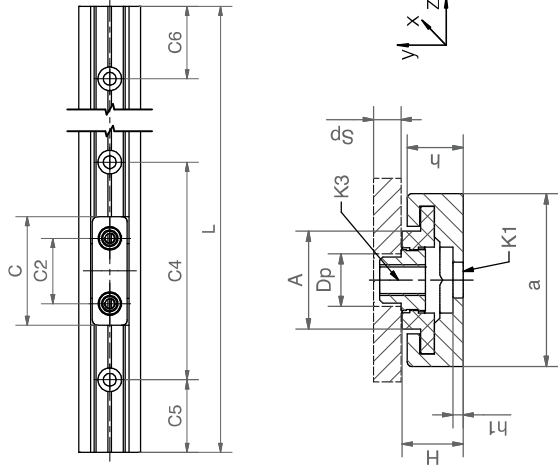

Guide rail – dimensions [mm]

Part No.	L	a	C4	C5	C6	h		h1	K1 ⁷³⁾	ly	Iz	Weight [g/m]
						Min.	Max.					
NS-01-17-□ ⁷²⁾	2,000	17	60	20	49.5	5.5	0.9	Ø3.5	1,700	120	150	150
NS-01-17-UNGEBOHRT-□ ⁷²⁾	2,000	17	-	-	-	5.5	0.9	-	1,700	120	150	150
NS-01-17-AR-□ ⁷²⁾	2,000	17	60	20	49.5	5.5	0.9	Ø3.5	1,700	120	150	150

Guide carriage – dimensions [mm]

Part No.	H	A	C	C2	K3 ⁷⁴⁾	Sp	Dp ¹⁵⁹⁾	Weight [g]
NW-02-17	6.0	9.6	20	14	M3	2.5	5.0	1.7
NW-02-17-P	6.0	9.6	20	14	M3	2.5	5.0	1.7
NW-22-17-30	6.0	9.6	30	18	M3	2.5	5.0	2.4
NW-22-17-40	6.0	9.6	40	28	M3	2.5	5.0	2.6

⁷²⁾ Please give the required length in mm, symmetrical standard hole pattern C5=C6

⁷³⁾ For cap screw with low head (e.g. DIN 7984, DIN 6912, EN ISO 1707)

⁷⁴⁾ Metal thread

¹⁵⁹⁾ Hole min. Ø



All elements can be ordered individually or as assembled systems

NS-01-17-1500: Guide rail, installation size 17, 1,500mm length

NK-02-17-02-500-LLY: Complete system with two solid plastic guide carriages with threaded pins, installation size 17, floating bearing in y-direction and 500mm guide rails with standard holes

Selection aid – guide carriage

Part No.	Single	Double	Through hole	Threaded pin	Threaded hole	Pre-load	Solid plastic	Clipped-on	Overmoulded	High temp.
NW-02-17	●			●			●			
NW-02-17-P	●			●		●	●			
NW-22-17-30		●		●			●			
NW-22-17-40		●		●			●			

Guide rails and carriages – installation size 40



Complete system



Order key

Type	Size	Options
drylin® N	NW - 01 - 40 - P - LLY	Guide carriages Type of carriage Rail width Pre-load Floating bearing in y-direction Type of carriage Floating bearing in y-direction Type of carriage: See selection aid Options: P: Pre-load Floating bearing: LLY: y-direction LLZ: z-direction LLYZ: yz-direction

Suitable for aluminium construction profiles



Standard
Without holes
Anti-reflect

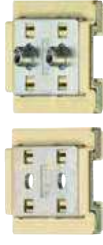

NW-01-40



NW-02-40



NW-11-40

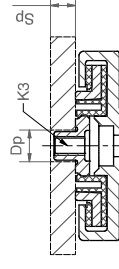
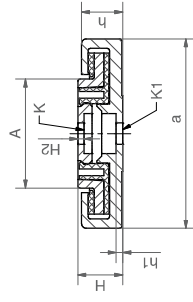
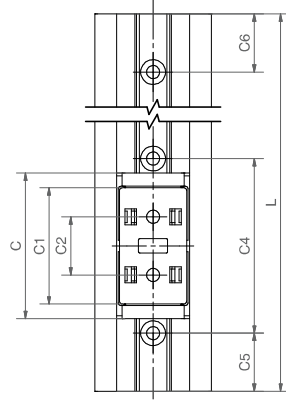

Guide rail – dimensions [mm]

Part No.	L		C4	C5 C6		h	h1	K1 ⁷³⁾	ly	lz	Weight [g/m]
	Max.	Min.		Max.	Min.						
NS-01-40-□ ⁷²⁾	3,000	40	60	20	49.5	8.7	1.3	Ø4.5	26,400	970	450
NS-01-40-JUNGEBOHRT-□ ⁷²⁾	3,000	40	-	-	-	8.7	1.3	-	26,400	970	450
NS-01-40-AR-□ ⁷²⁾	3,000	40	60	20	49.5	8.7	1.3	Ø4.5	26,400	970	450

Guide carriage – dimensions [mm]

Part No.	H		C	C1	C2	H2	K ⁷³⁾	K3 ⁷⁴⁾	Sp	Dp ⁵⁹⁾	Weight [g]
	±0.35	Min.									
NW-01-40	9.5	23.0	50	40	20	1.3	Ø4.5	-	-	-	30.0
NW-01-40-P	9.5	23.0	50	40	20	1.3	Ø4.5	-	-	-	30.0
NW-11-40	9.5	23.0	52	40	20	1.3	Ø4.5	-	-	-	30.0
NW-02-40	9.5	23.0	50	40	20	-	-	M4	5.0	6.5	30.0
NW-02-40-P	9.5	23.0	50	40	20	-	-	M4	5.0	6.5	30.0
NW-12-40	9.5	23.0	52	40	20	-	-	M4	5.0	6.5	30.0

⁷²⁾ Please give the required length in mm, symmetrical standard hole pattern C5=C6

⁷³⁾ For cap screw with low head (e.g. DIN 7984, DIN 6912, DIN 84, EN ISO 1707)

⁷⁴⁾ Metal thread

¹⁵⁹⁾ Hole min. Ø

All elements can be ordered individually or as assembled systems

NS-01-40-1500: Guide rail, installation size 40, 1,500mm length

NW-02-40-P-LLY: Guide carriage with threaded pin, installation size 40, pre-load, floating bearing in y-direction

NK-02-40-02-500-LLY: Complete system with two clipped-on guide carriages with threaded pins, installation size 40, floating bearing in y-direction and 500mm guide rails with standard holes

Selection aid – guide carriage

Part No.	Single	Double	Through hole	Threaded pin	Threaded hole	Pre-load	Solid plastic	Clipped-on	Over-moulded	High temp.
NW-01-40	●							●		
NW-01-40-P	●				●			●		
NW-11-40	●									●
NW-02-40	●			●				●		
NW-02-40-P	●			●				●		
NW-12-40	●			●						●

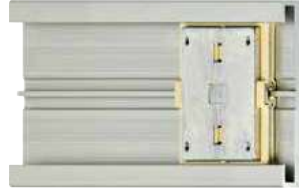

Complete system



Order key

Type	Size	Options
NW - 02 - 80 - LLY		
drylin® N Guide carriages	Type of carriage	Floating bearing in y-direction
Rail width		

Type of carriage:
See selection aid

Options:
Floating bearing:
LLY: y-direction
LLZ: z-direction
LLYZ: yz-direction



Without holes



NW-12-80



NW-02-80



Anti-reflect

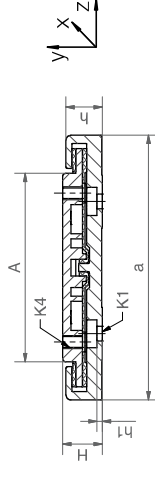
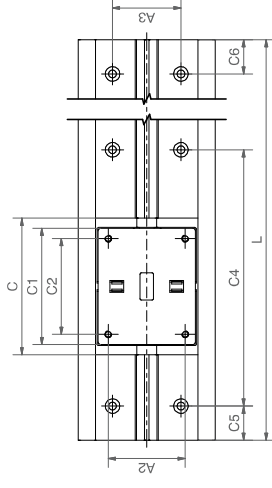

Guide rail (standard/without holes/AR anti-reflect) – Dimensions [mm]

Part No.	L Max.	a	A3	C4	C5	C6	h		h1	K1 ^{7a)}	ly	lz	Weight [g/m]
							Min.	Max.					
NS-01-80-□ ^{7a)}	4,000	80	150	40	25	99.5	11	1.5	Ø4.5	27,120	2,900	1,140	
NS-01-80-UNGEBOHRT-□ ^{7a)}	4,000	80	-	-	-	-	11	1.5	-	27,120	2,900	1,140	
NS-01-80-AR-□ ^{7a)}	4,000	80	150	40	25	99.5	11	1.5	Ø4.5	27,120	2,900	1,140	

Guide carriage – dimensions [mm]

Part No.	H	A	C	C1	C2	A2	K4 ^{7a)}	Weight [g]
NW-02-80	±0,35	57.0	80	68	56	45	M4	100.0
NW-12-80	12.0	57.0	83	68	56	45	M4	146.3

^{7a)} Please give the required length in mm, symmetrical standard hole pattern C5=C6

^{7a)} For cap screw with low head (e.g. DIN 7984, DIN 6912, DIN 84, EN ISO 1707)

^{7a)} Metal thread

Selection aid – guide carriage

Part No.	Single	Double	Through hole	Threaded pin hole	Threaded hole	Pre-load	Solid plastic	Clipped-on	Over-moulded	High temp.
NW-02-80	●				●			●		
NW-12-80	●				●				●	



All elements can be ordered individually or as assembled systems

NS-01-80-1500: Guide rail, size 80, 1,500mm length

NW-02-80-LLY: Guide carriage, clip-on, installation size 80, floating bearing in y-direction,

NK-02-80-02-500-LLY: Complete system with two clipped-on guide carriages with threaded pins, installation size 80, floating bearing in y-direction and 500mm guide rails with standard holes

drylin® N low-profile linear guides | Product range

Prism rails



Order key

Type	Installation size	Options
Guide rails for pre-load prism slide	NSV - 01 - 27 - UNGEBOHRT (without holes)	Installation size
Type		

drylin® N low-profile linear guides | Product range

Pre-load prism slide, standard design



Order key

Type	Installation size	Options
Pre-load prism slide	NWV - 21 - 27 - 35 - P05	Type of carriage Carriage length Rail width Pre-load

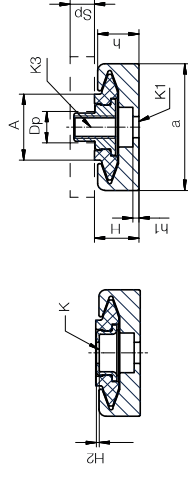
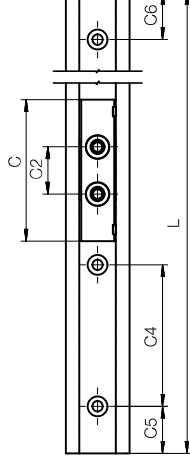
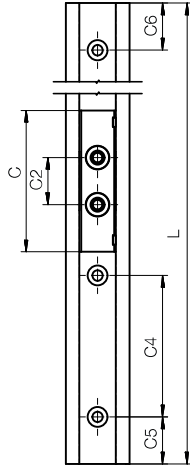

Guide rail – dimensions [mm]

Part No.	L	a	C4	C5	C6	h	h1	K1	ly	lz	Weight
NSV-01-27	3,000	27	60	20	49.5	8.8	1.1	Ø4.5	11,250	766	409
NSV-01-27-□ ^{7a)}	3,000	27	-	-	-	8.8	1.1	-	11,250	766	409

^{7a)} Please give the required length in mm, symmetrical standard hole pattern C5=C6

Guide carriage – dimensions [mm]

Part No.	Pre-load	H	A	C	C2	H2	K	K3	M ^{7b)}	SP	Dp ^{15b)}	Weight
NWV-21-27-35-P05	5	9.5	14	35	20	0.7	Ø4.5	-	-	-	-	6
NWV-21-27-35-P11	11	9.5	14	35	20	0.7	Ø4.5	-	-	-	-	6
NWV-21-27-35-P23	23	9.5	14	35	20	0.7	Ø4.5	-	-	-	-	6
NWV-21-27-35-P38	38	9.5	14	35	20	0.7	Ø4.5	-	-	-	-	6
NWV-22-27-35-P05	5	9.5	14	35	20	-	-	M4	1.2	5	5	11
NWV-22-27-35-P11	11	9.5	14	35	20	-	-	M4	1.2	5	5	11
NWV-22-27-35-P23	23	9.5	14	35	20	-	-	M4	1.2	5	5	11
NWV-22-27-35-P38	38	9.5	14	35	20	-	-	M4	1.2	5	5	11

^{7b)} Max. screw tightening torque

^{15b)} Hole min. Ø

Pre-load prism slide, long design

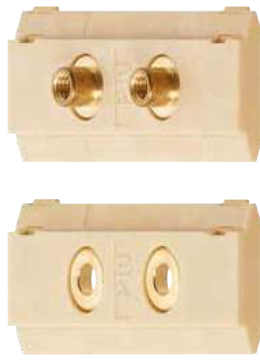

Order key

Type	Installation size	Options
Pre-load prism slide	NWV - 21 - 27 - 60 - P10	Pre-load
Type of carriage	Carriage length	
Rail width		

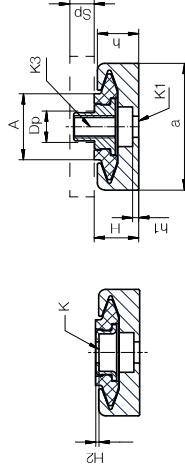
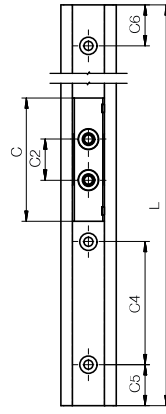

Guide carriage – dimensions [mm]

Part No.	Pre-load	H	A	C	C2	H2	K	K3	M ⁽⁷⁵⁾	SP	Dp ⁽⁵⁹⁾	Weight
NWV-21-27-60-P10	1.0	9.5	14	60	20	0.7	Ø4,5	-	-	-	-	10
NWV-21-27-60-P22	2.2	9.5	14	60	20	0.7	Ø4,5	-	-	-	-	10
NWV-21-27-60-P46	4.6	9.5	14	60	20	0.7	Ø4,5	-	-	-	-	10
NWV-21-27-60-P76	7.6	9.5	14	60	20	0.7	Ø4,5	-	-	-	-	10
NWV-22-27-60-P10	1.0	9.5	14	60	20	-	M4	1.2	5	6.5	13	
NWV-22-27-60-P22	2.2	9.5	14	60	20	-	M4	1.2	5	6.5	13	
NWV-22-27-60-P46	4.6	9.5	14	60	20	-	M4	1.2	5	6.5	13	
NWV-22-27-60-P76	7.6	9.5	14	60	20	-	M4	1.2	5	6.5	13	

⁷⁵⁾ Max. screw tightening torque

⁵⁹⁾ Hole min. Ø

Standard carriages



Part No.	Average displacement force [N]
NWV-21/22-27-35 P05	1.0
NWV-21/22-27-35 P11	2.2
NWV-21/22-27-35 P23	4.6
NWV-21/22-27-35 P38	7.6

Part No.	Guaranteed holding force [N]
NWV-21/22-27-35 P05	0.5
NWV-21/22-27-35 P11	1.1
NWV-21/22-27-35 P23	2.3
NWV-21/22-27-35 P38	3.8

Long carriages



Part No.	Average displacement force [N]
NWV-21/22-27-60-P10	2.0
NWV-21/22-27-60-P22	4.4
NWV-21/22-27-60-P46	9.2
NWV-21/22-27-60-P76	15.2

Part No.	Guaranteed holding force [N]
NWV-21/22-27-60-P10	1.3
NWV-21/22-27-60-P22	4.2
NWV-21/22-27-60-P46	6.2
NWV-21/22-27-60-P76	11.7



Note:

The average displacement force values apply to unloaded carriages at centric drive. The real displacement forces depend to a large extent on the displacement speed. At creep movement (few mm/min), the values are slightly over the guaranteed holding force. At higher displacement forces, the values can considerably exceed the average displacement force. The values do not apply for applications in which dirt and moisture ingress into the system.

drylin® N low-profile linear guides | Product range

Telescopic rails

- Robust plastic/aluminium version
- Lightweight
- Cost-effective
- Corrosion-free
- Continuous lengths up to 1,200mm (total extension)



Order key

Type	Size	Option
drylin® N	NT - 35 - 300	
Telescopic system	Rail width	Length [mm]



Order key over-extension

Type	Size	Option
drylin® N	NT - 35 - 300 - 320	
Telescopic system	Rail width	Length [mm]
		Over-extension [mm]



Order key partial extension

Type	Size	Option
drylin® N	NT - 35 - 300 - 200	
Telescopic system	Rail width	Length [mm]
		Partial extension [mm]

Option:
Partial extension
(e.g.: telescoped
length 300mm,
extended length
500mm)



Tip:

F_{max} calculated using this formula allows an easy manual use. Higher loads can be taken up by the system, but need a higher drive force.

NT-35-"L" - Total extension

C5: 20-49.5mm

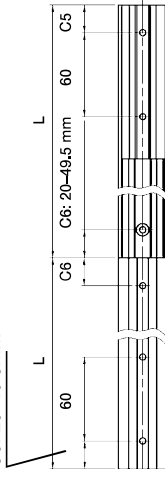

NT-35-"L"-L+20" - Over extension

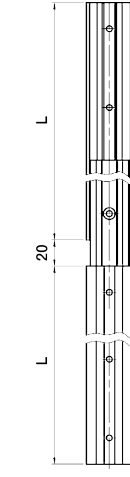

NT-35-"L"-B" - Partial extension

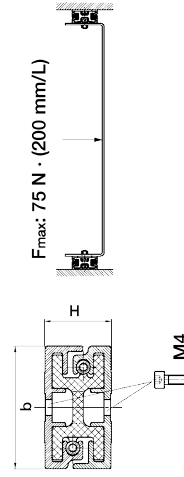
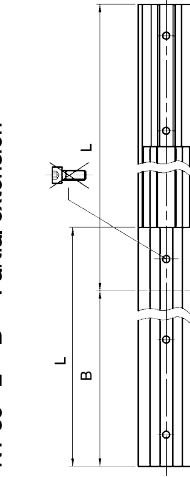

Dimensions [mm]

Part No.	b	H	L min.	L max.
NT-35-... mm	35	19	100	600

drylin® N low-profile linear guides | Product range

Telescopic rails with locking mechanism



Order key

Type	Size	Option
drylin® N	NT - LM - 35 - 300	
Telescopic system	Locking mechanism	Length [mm]

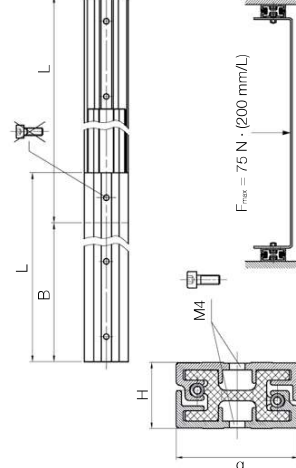

drylin® NT LM in adjustment of Perspex guard



drylin® NT LM in guard door adjustment in a machine tool

drylin® detent in end and centre position at full extension - dimensions [mm]

Part No.	b	H	Lmin	Lmax.
NT-LM-35-...mm	35	19	140	600

Individual position detent upon request; The length divided by the locking distance must be an even number.
e.g. Length 250mm, latching in 62.5mm step: $250/62.5 = 4$



Order example:

NT-LM-35-300: drylin® N telescopic rail with locking mechanism, 35mm width, retracted length 300mm

drylin® N low-profile linear guides | Product range

Accessories: Manual clamp



Order key

Type	Size	Version
drylin® N - Guide carriages	NW - 02 - 27 - 80 - HKA	Manual clamp
Type of carriage		
Rail width		
Carriage length		

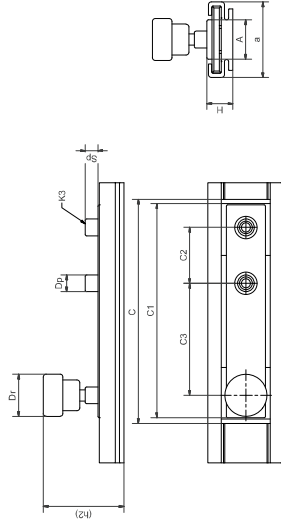

Dimensions [mm]

Part No.	H (h2)	A	a	C	C1	C2	C3	K3	M	Sp	Dp	Dr	Weight [g]	
NW-12-27-80-HKA	9.5	32	14	27	80	76	20	40	M4	1.2	5	6.5	15	32

M: Permissible torque of the complete system



Order example:
NW-12-27-80-HKA: Manual clamp for NW-12-27-80 carriage

drylin® N low-profile linear guides | Product range

Accessories: End caps



Order key

Type	Size
drylin® N - End cap	NSKB - 40
Push-fit	
Rail width	

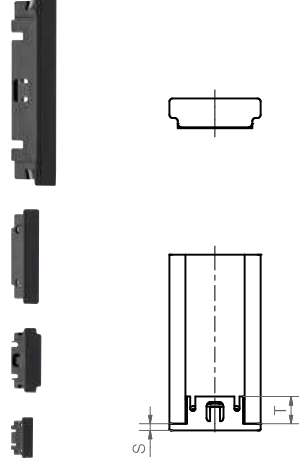

Dimensions [mm]

Part No.	S	T	For rail
NSKB-17	1.5	7	NS-01-17
NSKB-27	2.0	8	NS-01-27
NSK-40	1.5	8	NS-01-40
NSKB-80	2.0	17	NS-01-80



Order example:
NSK-40: End caps for guide rail size 40, bolted

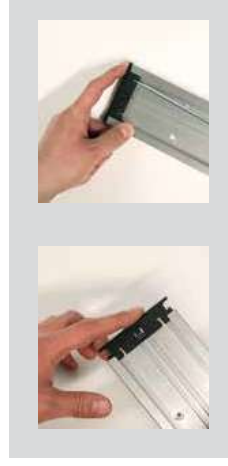

Easily assembled and disassembled by hand using a screwdriver. Part No.: NSKB

End caps for rail size 40, screwed
Part No.: NSK-40

drylin® N replacement plastic sliders (set)

Material iglidur® J

Carriage type	Part No.
	Sliding part set
NW-01/02-27	NEK-01-27
NW-01/02-27P	NEK-01-27-P
NW-01/02-27-LLY	NEK-01-27-LLY
NW-01/02-27-LLZ	NEK-01-27-LLZ
NW-01/02-40	NEK-02-40
NW-01/02-40P	NEK-01-40-P
NW-01/02-40-LLY	NEK-02-40-LLY
NW-01/02-40-LLZ	NEK-02-40-LLZ
NW-02-80	NEK-02-80
NW-02-80-LLY	NEK-02-80-LLY
NW-02-80-LLZ	NEK-02-80-LLZ

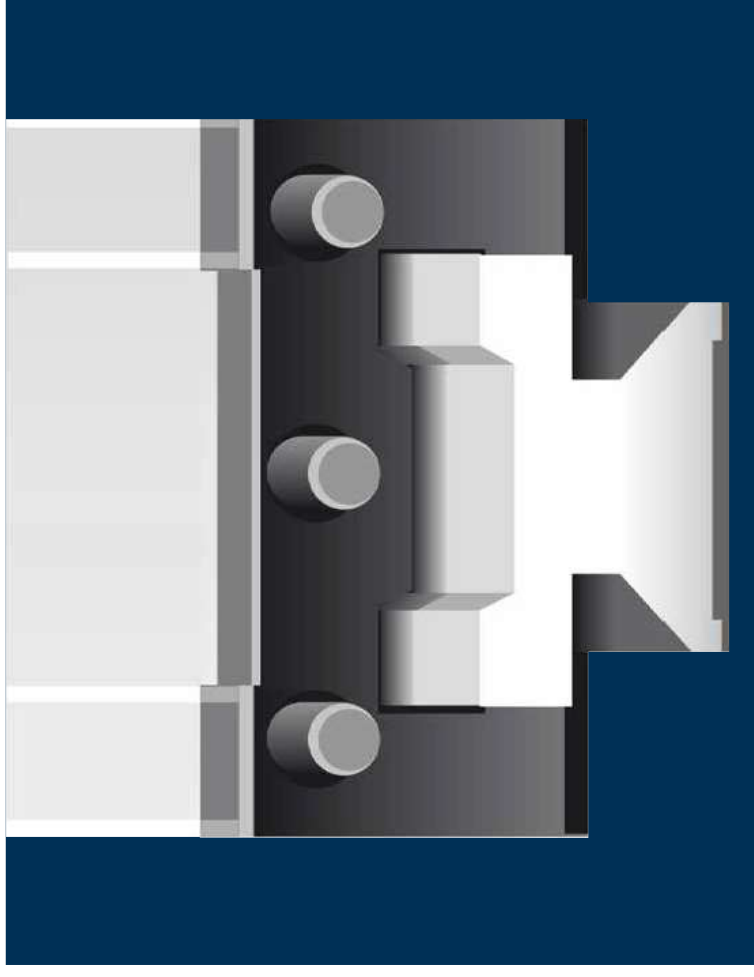

drylin® linear technology – drylin® T rail guides

Robust linear guides

Adjustable bearing clearance

Wear-resistant and durable

Dimensionally identical to recirculating
ball-bearing guides

Lubrication and maintenance-free

