

Suction cup F26 Silicone FCM, G1/4" male, 9914238



- Designed for opening bags in bag filling stations.
- Also suitable to handle thin and sensitive sheets, such as paper and plastic films.
- The thin, conformable lip and clever cleat pattern prevent sensitive object/sheet to get sucked in and damaged while giving enhanced lifting force.
- FDA approved silicone material.

General

Curve radius	25 mm
Movement, vertical max.	1.5 mm
Application	Bag opening/thin paper - slip sheets/film, Food contact materials (FDA & EU), non-detectable
Material	Silicone (SIL FDA)
Suction cup model	F
Suction cup shape	Flat
Volume	1.6 cm ³
Weight	4.1 g

Fitting

Fitting size	1/4"
Fitting style	Male
Fitting type	G-thread
Fitting option	None

Dimension

Height	38.5 mm
Outer diameter	26 mm
Outer diameter, actuated	27.3 mm

Performance — lifting forces

		
20 -kPa	11 N	9 N
60 -kPa	25 N	21 N
90 -kPa	31 N	26 N

Material

	Silicone (SIL FDA)
Colour	Transparent
Hardness	50 °Shore A
Temperature	-40 – 200 °C

Material resistance

	Silicone (SIL FDA)
Alcohol	++
Concentrated acids	-
Ethanol	N/A
Hydrolysis	+
Methanol	N/A
Oil	-
Oxidation	+++
Petrol	-
Wear resistance	++
Weather and ozone	+++

Dimensional drawings

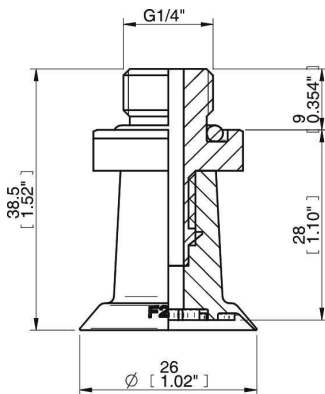

Values specified in the data sheet are tested at:

Room temperature	(20°C [68°F] ± 3°C [5.5°F])
Standard atmosphere	(101.3 [29.9 inHg] ± 1.0 kPa [0.3 inHg])
Relative humidity	0-100%
Compressed air quality	DIN ISO 8573-1 class 4

Spare parts

	Item no.
Suction cup F26 Silicone FCM	0201216
Fitting G1/4" male	0201967

Accessories

	Item no.
Fitting 1/8" NPSF female	0201969