



At the cutting edge of smart development, our line of electrical components help you create a smarter tool system.

CYLINDER SENSORS

	Sensor Type	Supply Voltage (VDC)	Applicable Component/Cylinder	Cable Length	Wires	Output	Weight (g)	Piab No.
RRK-93	Reed Switch	24	ISC / KHZ / SZD / SZS / PG / KZ RC	3m	2	24 VDC	29	0214591
RRK-M9P	Solid State Switch	4.5-28	ISC / KHZ / SZD / SZS / PG / KZ RC	3m	3	PNP	41	0214593
RRK-Y59B	Reed Switch	24	LPG 10-/PGR...S	3m	2	24 VDC	44	0214595

RRK-93

Product Code: RRK-93

- 2-Wire reed switch sensors have higher voltage resistance capability.



RRK-M9P

Product Code: RRK-M9P

- 3-Wire solid state switches have faster reaction time.
- Sensor with flying leads.



RRK-Y59B

Product Code: RRK-Y59B

- 2-Wire reed switch sensors have higher voltage resistance capability.



SOLID STATE SENSORS

RRK-DFSHP PNP

Product Code: RRK-DFSHP
Piab No. 0213128



RRK-DFSHN NPN

Product Code: RRK-DFSHN
Piab No. 0213129



- Magnetic solid state sensor.
- Sensors cylinder position by sensing a magnet on the piston.

Electrical Data	
Cable specification	2.8 Ø, 3C, Grey Oil Resistant PVC
Cable length	2m
Current, consumption	3 mA
Display	Red LED, Green LED
Supply voltage	5 – 30 VDC
Voltage drop, max	0.5 VDC (@ 200 mA)
EOAT (End Of Arm Tooling)	
Applicable Component / Cylinder	ISC / KHZ / SZD / SZS / PG / KZ RC
Switching logic	Solid state, normally open
Switching current	200 mA
Switching rating	6 W
Leakage current	0.01 mA
Switching frequency	1000 Hz
Protection, circuit	Power reverse polarity, surge suppression

CYLINDER SENSORS

	Sensor Type	Supply Voltage (VDC)	Applicable Component/Cylinder	Cable Length	Wires	Output	Weight (g)	Piab No.
RRK-Y7P	Solid State Switch	4.5-28	LPG 10 / PGR...-S	2m	3	PNP	51	0214597
SN 1.5	Ind. Proximity	10-30	GRZ	2m	3	NPN	30	0213252
SP 1.5	Ind. Proximity	10-30	GRZ	2m	3	PNP	29	0213250

RRK-Y7P

Product Code: RRK-Y7P

- 3-Wire solid state switches have faster reaction time.



SN 1.5

Product Code: SN 1.5

- NPN.
- 3 wire.



SP 1.5

Product Code: SP 1.5

- PNP.
- 3 wire.



CYLINDER SENSORS

	Sensor Type	Supply Voltage (VDC)	Applicable Component/Cylinder	Cable Length	Wires	Output	Weight (g)	Piab No.
RRK-Y7P-TP	Solid State Switch	4.5-28	LPG 10 / PGR...-S	0.5m	3	PNP	31	0214598
SN 1.5-P	Ind. Proximity	10-30	GRZ	200mm	3	NPN	12	0213253
SP 1.5-P	Ind. Proximity	10-30	GRZ	200mm	3	PNP	13	0213251

RRK-Y7P-TP

Product Code: RRK-Y7P-TP

- 3-Wire solid state switches have faster reaction time.



SN 1.5-P

Product Code: SN 1.5-P

- NPN.
- M8 3 pin, plug connector.



SP 1.5-P

Product Code: SP 1.5-P

- PNP.
- M8 3 pin, plug connector.



CYLINDER SENSORS

	Sensor Type	Supply Voltage (VDC)	Applicable Component/Cylinder	Cable Length	Wires	Output	Weight (g)	Piab No.
RRK-93-TP	Reed Switch	24	ISC / KH7 / SZD / SZS / PG / K7 / RC	0.5m	2	24VDC	10	0214592
RRK-M9P-TP	Solid State Switch	4.5-28	IST / KH2 / RC B-S / SZD	0.5m	3	PNP	10	0214594
RRK-Y59B-TP	Reed Switch	24	LPG 10 / PGR...-S	0.5m	2	24VDC	12	0214596

RRK-93-TP

Product Code: RRK-93-TP

- 2-Wire reed switch sensors have higher voltage resistance capability.
- M8 3 pin, plug connector.



RRK-M9P-TP

Product Code: RRK-M9P-TP

- 3-Wire solid state switches have faster reaction time.
- Sensor with connector end.
- M8 3 pin, plug connector.



RRK-Y59B-TP

Product Code: RRK-Y59B-TP

- 2-Wire reed switch sensors have higher voltage resistance capability.
- M8 3 pin, plug connector.



OPTICAL SENSORS

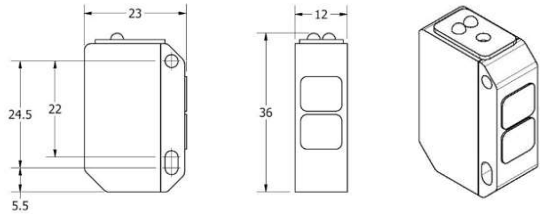

	Sensor Type	Supply Voltage (VDC)	Sensing Range (mm)	Cable Length	Wires	Quick Connector	Output	Weight (g)	Piab No.
LES-5	Diffuse Reflective	10-30	0-250	2m	3	-	PNP	86	0214518
LES-5P	Diffuse Reflective	10-30	0-250	150mm	3	3-Pin Plug	PNP	70	0214519
LRS-14	Diffuse Reflective	10-30	0-300	2m	3	-	PNP	91	0213254
LRS-18	Diffuse Reflective	10-30	0-400	2m	3	-	PNP	80	0213255

LES-5

Product Code: LES-5

- Diffuse photoelectric sensor.
- 0-250mm sensing range.
- Used for part presence when vacuum sensing is not available.
- Using the GGE 14-120 FS the sensor can mount to standard clamps.



LES-5P

Product Code: LES-5P

- Diffuse photoelectric sensor.
- 0-250mm sensing range.
- Used for part presence when vacuum sensing is not available.
- Using the GGE 14-120 FS the sensor can mount to standard clamps.



LRS-14

Product Code: LRS-14

- Diffuse photoelectric sensor.
- 0-300mm sensing range.
- used for part presence when vacuum sensing is not available.
- Using the GLA 14-120 the sensor can mount to standard clamps.
- 12mm threaded-barrel sensor.



LRS-18

Product Code: LRS-18

- Diffuse photoelectric sensor.
- 0-300mm sensing range.
- used for part presence when vacuum sensing is not available.
- Using the GLA 20-150 the sensor can mount to standard clamps.
- 18mm threaded-barrel sensor.



INDUCTIVE SENSORS

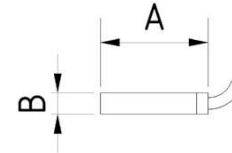

	A	B	Depth	Piab No.
FB - BI2 - Q5,5 - AP6X	28	5,5	8	0213390
FB - BI2 - Q5,5 - AP6X - 0,3 - PS	28	5,5	8	0213391

FB - BI2 - Q5,5 - AP6X

Product Code: FB - BI2 - Q5,5 - AP6X

FB - BI2 - Q5,5 - AP6X

- Inductive sensor.
- Cuboid.
- Height = 5.5 mm.
- Active surface on top.
- Plastic, PP.
- DC3 wire, 10...30 VDC, make contact, PNP output, cable connection.
- Length of cable: 2 m.
- Reference switching distance: 2 mm, flush.



FB - BI2 - Q5,5 - AP6X - 0,3 - PS

Product Code: FB - BI2 - Q5,5 - AP6X - 0,3 - PS

FB - BI2 - Q5,5 - AP6X - 0,3 - PS

- Inductive sensor.
- Cuboid.
- Height = 5.5 mm.
- Active surface on top.
- Plastic, PP.
- DC3 wire, 10...30 VDC make contact, PNP output, pin-and-socket connector, M8 x 1.
- Length of cable: 0.3 m.
- Reference switching distance: 2 mm, flush.



REFLECTION LIGHT SWITCH

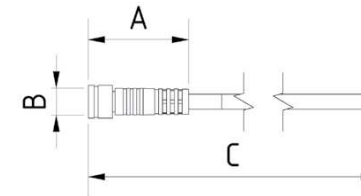

Cable socket, 3-pin FB - KDG - M8 - 3 - 2m

- Cable socket 2m.
- M8 3 pin connector straight.
- 3 x 0,34 mm².
- PUR.
- Cable socket with stable knurled nut made of aluminum.
- For fast replacement of the connected components.

	A	B	C	Piab No.
FB - KDG - M8 - 3 - 2m	30,5	M8	2M	0213394



REFLECTION LIGHT SWITCH

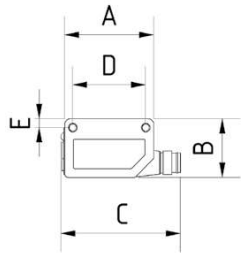

- Reflection light switch.
- Background suppression.
- Standard miniature housing with M3 threaded mounting holes.
- 11mm x 31mm x 20mm.
- Sensing range max. 5mm - 100mm.
- Sensing range 20mm - 100mm.
- Type of light: visible redlight.
- Connector M8, ME3-pin.
- Material: plastic.

	A	B	C	D	E	Depth	Piab No.
FB-WTB8-P2111	31	20	42	25.4	3	11	0213395
FB-GTB6-P5211	31.5	21	42	25.4	3	12	0213393



SENSOR MOUNT

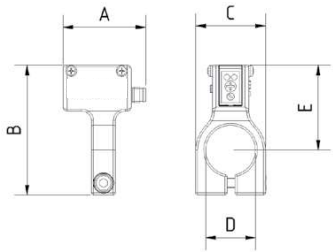

- Sensor devices SH25 for WTB8.
- Easy to mount.
- Protects circumferential.
- Very light.
- Material: plastic.

	A	B	C	D	E	Piab No.
SH25-WTB8	42	65	25	25	43	0213456
SH25-GTB6	42	65	35	25	43	0213455



TERMINAL ENCLOSURE

GEO-10

Product Code: GEO-10

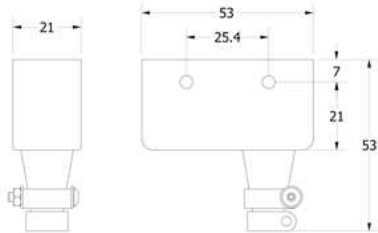

- GEO houses and protects an SEO's terminals.

	Description	Weight (g)	Piab No.
GEO-10	Terminal Enclosure for SEO 10	15	0214315

MECHANICAL SENSOR

SEO-5

Product Code: SEO-5

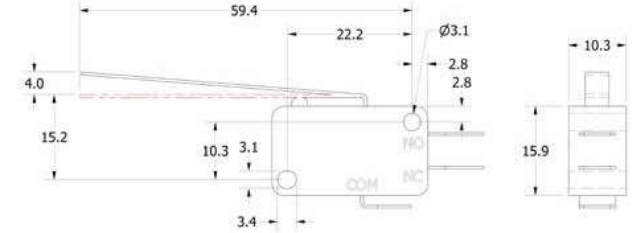
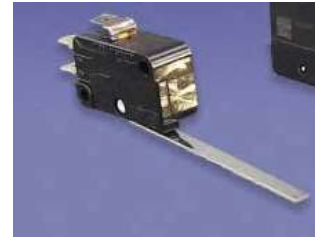

- Provides part present sensing when vacuum sensors can't be used and a short sensing range is necessary.
- SEO sensor can be used with standard mounting clamps when attached to a GGE 14-120 Fs.

	Description	Max. Supply Voltage	Wires	Weight (g)	Piab No.
SEO-5	Mechanical Switch	125 VDC (0.1A)/125 VAC	2	18	0214611

SEO-10

Product Code: SEO-10

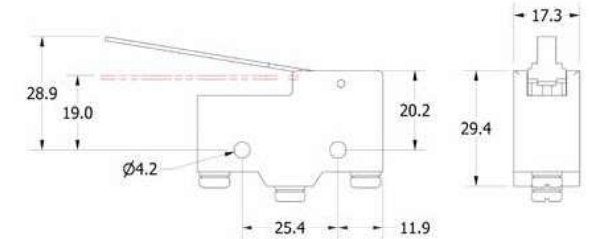

- Provides part present sensing when vacuum sensors can't be used and a short sensing range is necessary.
- SEO sensor can be used with standard mounting clamps when attached to a GGE 14-120 FS.

	Description	Max. Supply Voltage	Wires	Weight (g)	Piab No.
SEO-10	Mechanical Switch	125 VDC (0.1A)/125 VAC	2	32	0214610

ELECTRICAL CONNECTORS FEMALE

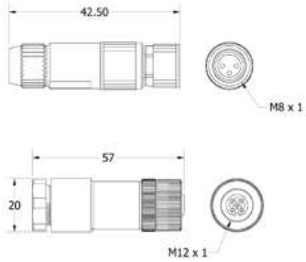

- Field wireable screw down terminal cable ends.
- No soldering required.

	Connector Size	Pins	Piab No.
TFP-3	M8	3	0214715
TFP-5	M12	5	0214716

TFP-3
Product Code: TFP-3

TFP-5
Product Code: TFP-5



ELECTRICAL CONNECTORS MALE

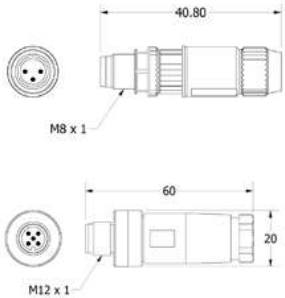

- Field wireable screw down terminal cable ends.
- No soldering required.

	Connector Size	Pins	Piab No.
TMP-3	M8	3	0214717
TMP-5	M12	5	0214718

TMP-3
Product Code: TMP-3

TMP-5
Product Code: TMP-5



QEC-FPC FEMALE PLUG HD15 1.5 METER CABLE

Product Code: QEC-FPC
Piab No. 0212969

- 5-Foot molded HD15F to open with custom stripping dimension.



QEC-MPC MALE PLUG HD15 1.5 METER CABLE

Product Code: QEC-MPC
Piab No. 0212970

- 5-Foot molded HD15M to open with custom stripping dimension.



QEC-FSC FEMALE SOLDER CONNECTOR

Product Code: QEC-FSC
Piab No. 0214585



- Assemble your own DB and HD connectors to replace worn out connectors or convert existing cables for different uses. Crimp-on connectors are faster to assemble than solder connectors. Shielded connectors prevent electromagnetic interference (EMI). Crimper (sold separately) is ratchet style to ensure a secure crimp with less force. Extraction tool (sold separately) allows you to remove the pins after crimping.
- Computer solder connector, HD15 connection, unshielded socket.
- Solder unshielded socket 30-20 plastic housing.

ELECTRICAL CONNECTORS

- Electrical connector for the QST / QSR.
- QEC-T is the tool side and the QEC-R is the robot side.
- 15 conductor plugs.

	A	B	C	Weight	Piab No.
QEC-R	17	38	47	50	0212967
QEC-T	17	38	47	50	0212968

QEC-R ELECTRICAL CONNECTOR FOR QSR

Product Code: QEC-R



QEC-T ELECTRICAL CONNECTOR FOR QST

Product Code: QEC-T



CABLE

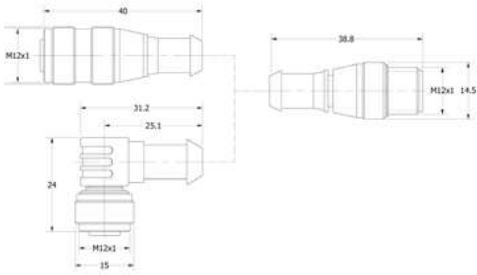

- Threaded plug extension cables.
- Types available for sensors, PJB's, AJB's, and J-Boxes.
- High-flexibility insulation for long cable life.

	Connector Size	Female Connector	Male Connector	# of Leads (Wires)	Length (Meters)	Weight (g)	Piab No.
FW8-SW5	M12	Straight	Wireable	8	5	230	0214309
FW8-RW5	M12	Right	Wireable	8	5	250	0214307
FW8-SW10	M12	Straight	Wireable	8	10	480	0214308
FW8-RW10	M12	Right	Wireable	8	10	500	0214306

FW8-SW5

Product Code: FW8-SW5



FW8-RW5

Product Code: FW8-RW5



FW8-SW10

Product Code: FW8-SW10



FW8-RW10

Product Code: FW8-RW10



CABLE

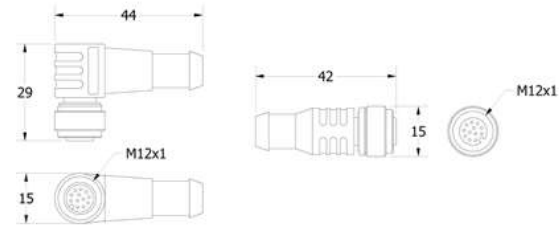

- Flexible for long life.
- Cables and cable sets for TB junction box.

	Connector Size	Female Connector	Male Connector	# of Conductors	Length (Meters)	Piab No.
FW12-SW2	M12	Straight	Wireable	12	2	0222659
FW12-SW4	M12	Straight	Wireable	12	4	0222660
FW12-SW10.1	M12	Straight	Wireable	12	10	0222661
FW12-SR2	M12	Straight	Right	12	2	0222662
FW12-SR4	M12	Straight	Right	12	4	0222663
FW12-SR10	M12	Straight	Right	12	10	0222664

FW12-SW2

Product Code: FW12-SW2



FW12-SW4

Product Code: FW12-SW4



FW12-SW10.1

Product Code: FW12-SW10.1



FW12-SR2

Product Code: FW12-SR2



FW12-SR4

Product Code: FW12-SR4



FW12-SR10

Product Code: FW12-SR10



CABLE

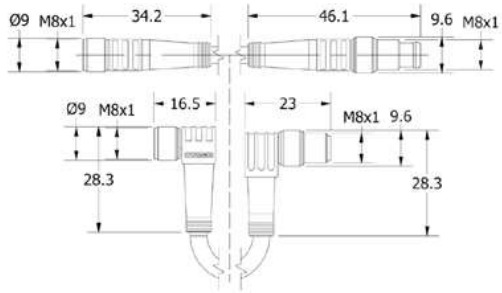

- Threaded plug extension cables.
- Types available for sensors, PJB's, AJB's, and J-Boxes.
- High-flexibility insulation for long cable life.

	Connector Size	Female Connector	Male Connector	# of Leads (Wires)	Length (Meters)	Weight (g)	Piab No.
FM3-SS.5	M8	Straight	Straight	3	0.5	25	0214283
FM3-RS.5	M8	Right	Straight	3	0.5	25	0214277
FM3-SR.5	M8	Straight	Right	3	0.5	25	0214280
FM3-RR.5	M8	Right	Right	3	0.5	23	0214274

FM3-SS.5

Product Code: FM3-SS.5



FM3-RS.5

Product Code: FM3-RS.5



FM3-SR.5

Product Code: FM3-SR.5



FM3-RR.5

Product Code: FM3-RR.5



CABLE

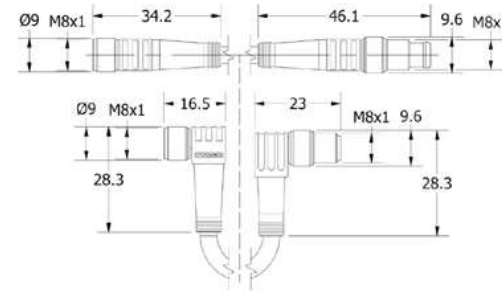

- Threaded plug extension cables.
- Types available for sensors, PJB's, AJB's, and J-Boxes.
- High-flexibility insulation for long cable life.

	Connector Size	Female Connector	Male Connector	# of Leads (Wires)	Length (Meters)	Weight (g)	Piab No.
FM3-SS1.3	M8	Straight	Straight	3	1	35	0214284
FM3-RS1	M8	Right	Straight	3	1	35	0214278
FM3-SR1	M8	Straight	Right	3	1	35	0214281
FM3-RR1	M8	Right	Right	3	1	36	0214275

FM3-SS1.3

Product Code: FM3-SS1.3



FM3-RS1

Product Code: FM3-RS1



FM3-SR1

Product Code: FM3-SR1



FM3-RR1

Product Code: FM3-RR1



CABLE

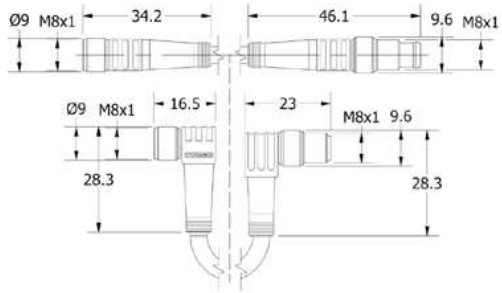

- Threaded plug extension cables.
- Types available for sensors, PJB's, AJB's, and J-Boxes.
- High-flexibility insulation for long cable life.

	Connector Size	Female Connector	Male Connector	# of Leads (Wires)	Length (Meters)	Weight (g)	Plab No.
FM3-SS2	M8	Straight	Straight	3	2	62	0214285
FM3-RS2	M8	Right	Straight	3	2	65	0214279
FM3-SR2	M8	Straight	Right	3	2	61	0214282
FM3-RR2	M8	Right	Right	3	2	65	0214276

FM3-SS2

Product Code: FM3-SS2



FM3-RS2

Product Code: FM3-RS2



FM3-SR2

Product Code: FM3-SR2



FM3-RR2

Product Code: FM3-RR2



CABLE

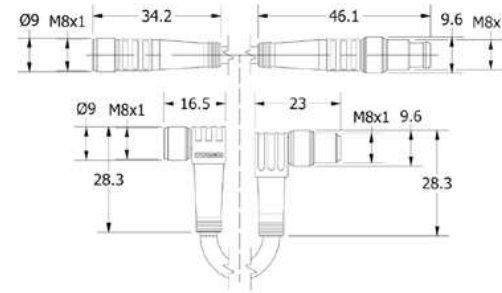

- Threaded plug extension cables.
- Types available for sensors, PJB's, AJB's, and J-Boxes.
- High-flexibility insulation for long cable life.

	Connector Size	Female Connector	Male Connector	# of Leads (Wires)	Length (Meters)	Weight (g)	Plab No.
FW3-SW2	M8	Straight	Wireable	3	2	60	0214299
FW3-RW2	M8	Right	Wireable	3	2	60	0214297
FW3-SW4	M8	Straight	Wireable	3	4	115	0214300
FW3-RW4	M8	Right	Wireable	3	4	115	0214298

FW3-SW2

Product Code: FW3-SW2



FW3-RW2

Product Code: FW3-RW2



FW3-SW4

Product Code: FW3-SW4



FW3-RW4

Product Code: FW3-RW4



CABLE

	Connector Size	Female Connector	Male Connector	# of Leads (Wires)	Length (Meters)	Weight (g)	Pliab No.
FM5-SS3	M12	Straight	Straight	5	3	160	0214289
FM5-RS3	M12	Right	Straight	5	3	160	0214287
FM5-SS10	M12	Straight	Straight	5	10	410	0214288
FM5-RS10	M12	Right	Straight	5	10	410	0214286
FW5-SW3	M12	Straight	Wireable	5	3	160	0214304
FW5-SW5	M12	Straight	Wireable	5	5	250	0214305
FW5-RW5	M12	Right	Wireable	5	5	250	0214302
FW5-SW10	M12	Straight	Wireable	5	10	410	0214303
FW5-RW10	M12	Right	Wireable	5	10	410	0214301

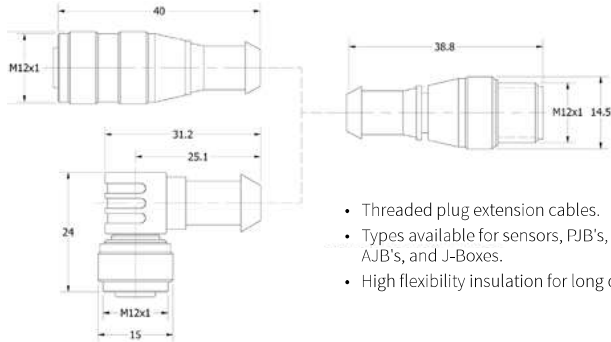

- Threaded plug extension cables.
- Types available for sensors, PJB's, AJB's, and J-Boxes.
- High flexibility insulation for long cable life.

FM5-SS3
Product Code: FM5-SS3



FM5-RS3
Product Code: FM5-RS3



FM5-SS10
Product Code: FM5-SS10



FM5-RS10
Product Code: FM5-RS10



FW5-SW3
Product Code: FW5-SW3



FW5-SW5
Product Code: FW5-SW5



FW5-RW5
Product Code: FW5-RW5



FW5-SW10
Product Code: FW5-SW10



FM5-RW10
Product Code: FM5-RW10



JUNCTION BOXES

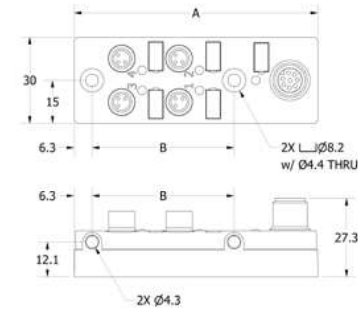
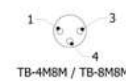
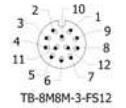

- Pass-through junction box with screw in terminals.
- Works with PNP or NPN sensors.
- Compact design for easy mounting on almost any tool.
- Female input connectors.
- Male output connectors.
- Can use standard channel nuts to mount to aluminum profile.

	Inputs	Logic	Supply Voltage (VDC)	Output Connector Size	Output Connector Pins	Signal Output	A	B	Pliab No.
TB-4M8M-3-FS8	4	PASS THROUGH	30	M12	8	PNP / NPN	85	49.5	0222681
TB-8M8M-3-FS12	8	PASS THROUGH	30	M12	12	PNP / NPN	125	89.5	0222682

TB-8M8M-3-FS12

	Pin #
V+	1
V-	2
Position 1	3
Position 2	4
Position 3	6
Position 4	8
Position 5	5
Position 6	9
Position 7	7
Position 8	10

TB-4M8M-3-FS8

	Pin #
V+	5
V-	7
Position 1	1
Position 2	2
Position 3	3
Position 4	4

TB-4M8M / TB-8M8M

	Pin #
V+	1
V-	3
Position 1	4

TB-4M8M-3-FS8

Product Code: TB-4M8M-3-FS8



TB-8M8M-3-FS12

Product Code: TB-8M8M-3-FS12



JUNCTION BOXES

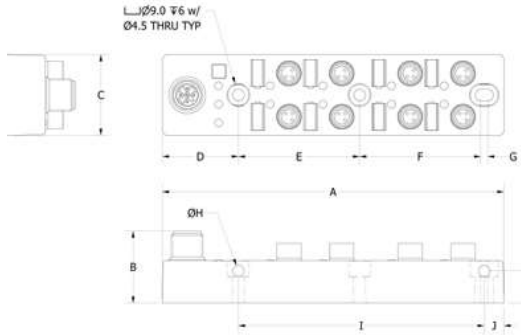

The VL31 series junction box is capable of putting PNP sensors in series providing 1 or more signals for the robot. This saves in reducing the number of inputs needed by the robot. The AND / OR version allows for all sensors in series (AND) or if only 1 of the sensors are made (OR). The AND / AND version allows for all of the sensors in series or half of the sensors in series and the other half in series for 2 signals. The Jumper FB-VK000042 must be used if all of the positions are not used by sensors.

	A	B	C	D	E	F	G	H	I	J	K	Piab No
FB VL310104	88.2	27.3	30.6	28.9	49.6	-	7.2	4.3	49.6	9.7	12.2	0216067
VL310114	88.2	27.3	30.6	28.9	49.6	-	7.2	4.3	49.6	9.7	12.2	0222640
FB VL310108	129.7	27.3	30.6	28.9	46	46	2.6	4.3	93.3	7.5	12.2	0216068
VL310118	129.7	27.3	30.6	28.9	46	46	2.6	4.3	93.3	7.5	12.2	0222641
FB VL31010A	149.7	27.3	30.6	28.9	46	66	2.6	4.3	113.3	7.5	12.2	0216069
VL31011A	149.7	27.3	30.6	28.9	46	66	2.6	4.3	113.3	7.5	12.2	0222642

ELECTRICAL DATA	FB VL310104	VL310114	FB VL310108	VL310118	FB VL31010A	VL31011A
input	PNP NO					
output	AND 4-way, OR 4-way	AND, 2 x 2-way, 4-way	AND 8-way, OR 8-way	AND, 2 x 4-way, 8-way	AND 10-way, OR 10-way	AND, 2 x 5-way, 10-way
operating voltage	10 ... 30 VDC					
current consumption (max. load)	1A					
output current (max. load)	200mA					
insulation resistance	≥ 108Ω					
module connection	M12-connector, 4-pin	M12-connector, 5-pin	M12-connector, 4-pin	M12-connector, 5-pin	M12-connector, 4-pin	M12-connector, 5-pin
sensor connection	4 x M8-coupling, 3-pin					
applicable cable series	FB-VK200421	FW5 Series	FB-VK200421	FW5 Series	FB-VK200421	FW5 Series

MECHANICAL DATA	FB VL310104	VL310114	FB VL310108	VL310118	FB VL31010A	VL31011A
input status LED	4 x yellow LED	4 x yellow LED	8 x yellow LED	8 x yellow LED	10 x yellow LED	10 x yellow LED
output status LED	1 x yellow LED	1 x yellow LED per output	1 x yellow LED	1 x yellow LED per output	1 x yellow LED	1 x yellow LED per output
housing material	plastic PA					
contact material	Cu/Zn, gold-plated					
Operating temperature	-30 ... +90°C					
Rating	IP67					

M12-Connector pin assignment	AND / OR	AND / AND
1	24 VDC	24 VDC
2	output OR	output 1
3	0 VDC	0 VDC
4	output AND	output 2
5	-	output all

FB-VL310104/ VL310114



FB-VL310108/ VL310118



FB-VL31010A/ VL31011A



JUMPER PLUG

FB-VK000042

Product Code: FB-VK000042
Piab No. 0216065



CABLE SOCKET

FB-VK200421

Product Code: FB-VK200421
Piab No. 0216066



SENSOR LOGIC BOXES

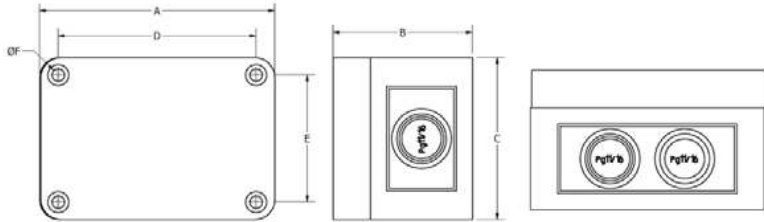

- Minimize interface wiring and maximize utilization of controller inputs by providing termination/ power distribution points for up to 2 inputs.
- Inputs/ Outputs can be either current sourcing (PNP), sinking (NPN), or a combination of the two.
- Includes enclosure and cable grips.
- Accessible terminals allow for easy wiring.
- May be installed into "Snap Track" on DIN mounting.
- Solid State logic for long life.
- KK's provide "Pass Through" functionality.
- RPL's provide "AND" Logic functionality.
- RPL can convert PNP signals to NPN and NPN signals to PNP.
- US PAT. #6,812,593.



	Inputs	Logic	Supply Voltage (VCD)	Signal Output	A	B	C	D	E	F	Weight (g)	Piab No.
RPL 2	2	AND (series)	15-35	PNP /NPN / RELAY 'C'	94	56	65	79	50	4.5	179	0213256
RPL 4	4	AND (series)	15-35	PNP /NPN / RELAY 'C'	94	56	65	79	50	4.5	184	0213257
RPL 6	6	AND (series)	15-35	PNP /NPN / RELAY 'C'	130	56	94	115	79	4.5	280	0213258
RPL 8	8	AND (series)	15-35	PNP /NPN / RELAY 'C'	130	56	94	115	79	4.5	297	0213259
KK 1	1-4	Pass Through / Wireable AND	15-35	(same as input)	94	56	65	79	50	4.5	182	0213260
KK 2	1-8	Pass Through / Wireable AND	15-35	(same as input)	130	56	94	115	79	4.5	298	0213261

ELECTRICAL DISTRIBUTION BOXES

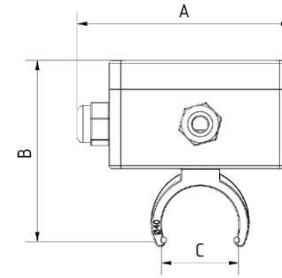

Electrical distribution boxes (EDB) incl. EASY clips

- Seamless fixing of the EDB at the stay pipe.
- No need for a complex screwing down on an aluminum plate.

	A	B	C	Depth	Including Fixing Clips for Aluminum Pipe	Cable / Outputs	Piab No.
EVB-19-25-1m-ST	118	72	25	145	AR40 x 4	including Schunk-connector, 1 m cable with 29 leads, numbers of outputs = 19	0216026
EVB-19-40-1m-ST	118	72	40	145	AR40 x 4	including Schunk-connector, 1 m cable with 25 leads, numbers of outputs = 19	0216027
EVB-19-25-1m	118	62	25	145	AR25 x 5	with cable, 1m	0213365
EVB-19-40-1m	118	72	40	145	AR40 x 4	numbers of outputs = 19	0213366



CABLE CONNECTOR

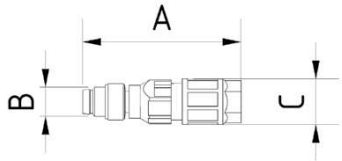

- Sensor/actuator connector.
- M8 3-PIN straight connector.
- Max. cable diameter 5.0 mm.



	A	B	C	Piab No.
FB-EST-M8-3P	43	N8	Diameter 12.5	0213392

SENSOR GRIPPER ARM

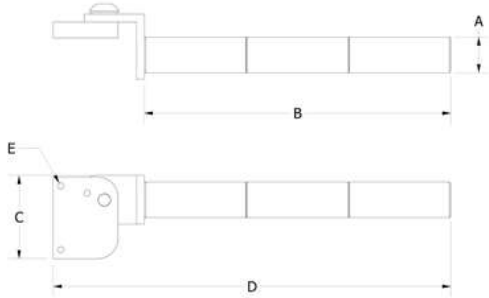

- Allows LES and SEO sensors to mount to standard mounting clamps.
- Top bracket adjusts angle to optimize sensing position.

	A	B	C	D	E	Sensor (sold separately)	Weight (g)	Piab No.
GGE 14-120 FS	14	120	32.5	156	3.5	LES-S / LES 5 P	54	0214323
GGE 14-120 FB	14	120	32.5	156	M3	SEO-5/SFO-10	55	0215339

PIAB OFFERS FULL RANGE OF PALLETIZING END OF ARM TOOLS - HEAVY DUTY ADJUSTABLE BAG GRIPPERS WITH 25 & 50 KG PAYLOADS FOR PALLETIZING PLASTIC, WOVEN CLOTH OR PAPER BAGS.

The grippers come in three versions; fixed bag width (FBG), adjustable bag width (ABG), and servo adjustable bag width (SBG). All versions comes with independent Decking Plates square-up and align the bag for precise placement on the pallet and creates a very tight loading pattern. Top mounted Bag Clamps maintain bag position on the tool during robot travel to the pallet and allows for high speed and precision in the movement. Slip Sheet and Pallet Hook options are available to increase the flexibility even further.



The FBG fixed width models are for your operation with low frequency of bag size changes, the FBG can be re-adjusted within 4 minutes to fit the new bag size.

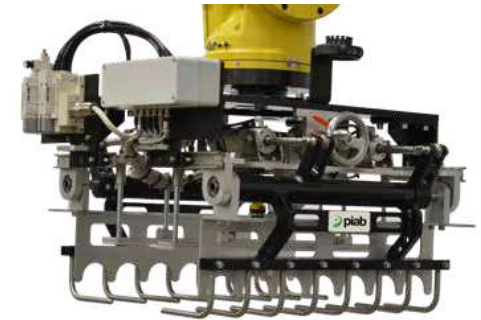

The ABG adjustable width model are for a low to medium frequency of bag changes, the ABG can be re-adjusted within 30 seconds to fit the new bag size.



The SBG servo adjustable model, can be adjusted according to your need within seconds and is suitable for the medium to high frequency of bag changes.



If your need is not covered Piab also produces custom made version for your unique application.