

> LTH30 RF

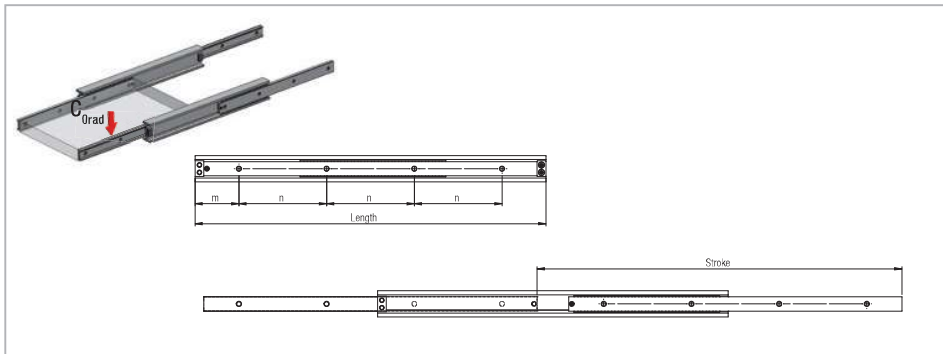

Fig. 46

Type	Size	Length		Stroke	Load capacity per pair		m [mm]	n [mm]	Number of holes
		L [mm]	H [mm]		C _{Orad} [N]	C _{max} [N]			
LTH	30	250	285	on request	404	1008	25	100	3
		300	323				50		
		350	377				25		
		400	416				50		4
		450	485				25		
		500	523				50		5
		550	577				25		
		600	615				50		6
		650	685				25		
		700	723				50		7
		750	777				25		
		800	815				50		8
		850	884				25		
		900	923				50		9
		950	977				25		
		1000	1015				50		10
1050	1084	25							
1100	1123	50	11						
1150	1176	25							
1200	1215	50	12						

Tab. 21

> LTH30 KF

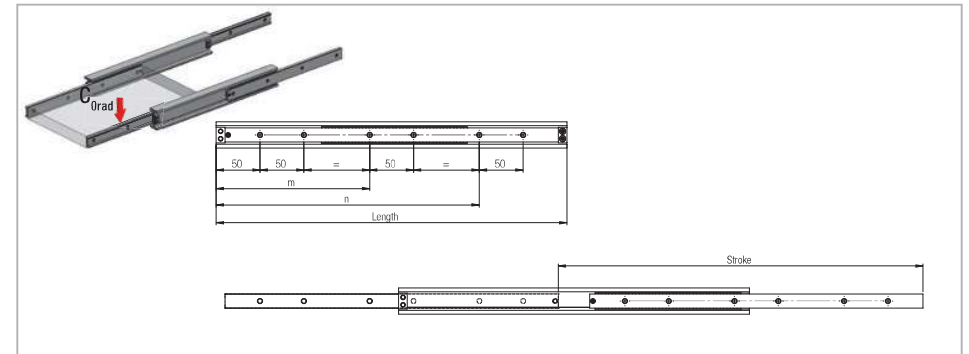

Fig. 47

Type	Size	Length		Stroke	Load capacity per pair		m [mm]	n [mm]	Number of holes
		L [mm]	H [mm]		C _{Orad} [N]	C _{max} [N]			
LTH	30	250	285	on request	404	1008	-	150	4
		300	323				200		
		350	377				250	6	
		400	416				175		300
		450	485				200		350
		500	523				225		400
		550	577				250		450
		600	615				275		500
		650	685				300		550
		700	723				325		600
		750	777				350		650
		800	815				375		700
		850	884				400		750
		900	923				425		800
		950	977				450		850
		1000	1015				475		900
1050	1084	500	950						
1100	1123	525	1000						
1150	1176	550	1050						
1200	1215	575	1100						

Tab. 22

> LTH30 S

... S version with reinforced and dampened end stops made of stainless steel

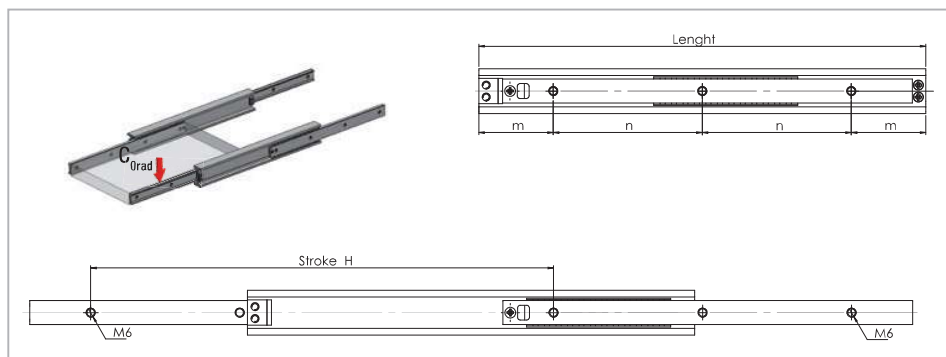

Fig. 48

Type	Size	Length L [mm]	Stroke H [mm]	Load capacity per pair		m [mm]	n [mm]	Number of holes
				C _{0rad} [N]	C _{0ax} [N]			
LTH...S	30	300	310	816	on request	50	100	3
		350	364	880		75		
		400	402	994		50		
		450	472	1032		75		4
		500	510	1330		50		
		550	564	1498		75		5
		600	618	1392		50		
		650	671	1276		75		6
		700	725	1178		50		
		750	764	1138		75		7
		800	817	1060		50		
		850	871	992		75		8
900	925	932	50					
950	979	878	75	9				
1000	1017	856	50					
1050	1071	810	75	10				
1100	1109	790	50					
1150	1179	732	75	11				
1200	1217	718	50					

Tab. 23

> LTH45 RF

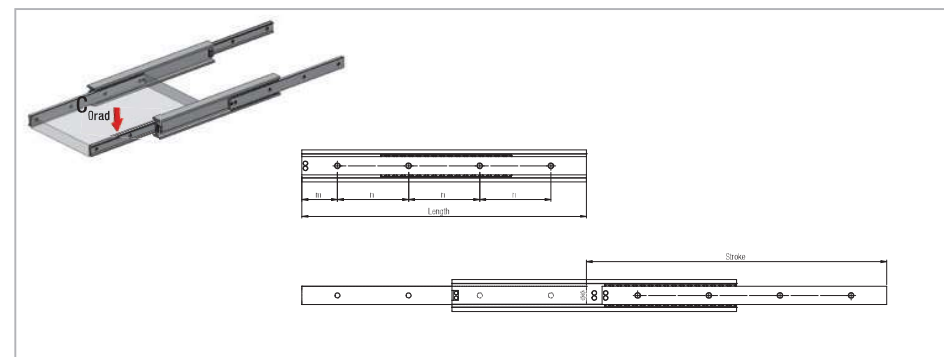

Fig. 49

Type	Size	Length L [mm]	Stroke H [mm]	Load capacity per pair		m [mm]	n [mm]	Number of holes
				C _{0rad} [N]	C _{0ax} [N]			
LTH	45	250	276	2610	on request	25	100	3
		300	310	2824		50		
		350	388	2820		25		
		400	422	2842		50		4
		450	478	2864		25		
		500	512	2900		50		5
		550	590	2764		25		
		600	624	3032		50		6
		650	680	3252		25		
		700	714	3346		50		7
		750	770	3084		25		
		800	826	2860		50		8
		850	882	2666		25		
		900	916	2614		50		9
		950	972	2450		25		
1000	1028	2306	50	10				
1050	1084	2178	25					
1100	1118	2144	50	11				
1150	1174	2034	25					
1200	1230	1934	50	12				
1250	1286	1842	25					
1300	1320	1818	50	13				
1350	1376	1738	25					
1400	1410	1716	50	14				
1450	1488	1596	25					
1500	1522	1578	50	15				

Tab. 24

> LTH45 KF

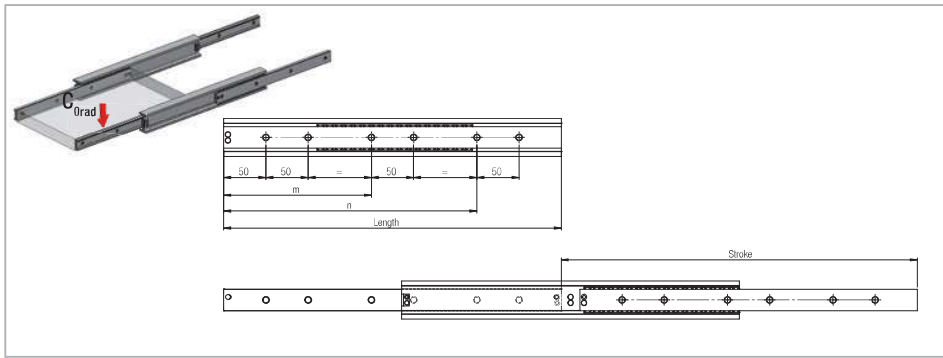

Fig. 50

Type	Size	Length L [mm]	Stroke H [mm]	Load capacity per pair		m [mm]	n [mm]	Number of holes
				C_{Drad} [N]	C_{Dax} [N]			
LTH	45	250	276	2610	on request	-	150	4
		300	310	2824			200	
		350	388	2820			250	
		400	422	2842			175	
		450	478	2864		200	350	
		500	512	2900		225	400	
		550	590	2764		250	450	
		600	624	3032		275	500	
		650	680	3252		300	550	
		700	714	3346		325	600	
		750	770	3084		350	650	
		800	826	2860		375	700	
		850	882	2666		400	750	
		900	916	2614		425	800	
		950	972	2450		450	850	
		1000	1028	2306		475	900	
		1050	1084	2178		500	950	
		1100	1118	2144		525	1000	
		1150	1174	2034		550	1050	
		1200	1230	1934		575	1100	
1250	1286	1842	600	1150				
1300	1320	1818	625	1200				
1350	1376	1738	650	1250				
1400	1410	1716	675	1300				
1450	1488	1596	700	1350				
1500	1522	1578	725	1400				

Tab. 25

> LTH45 S

... S version with reinforced and dampened end stops made of stainless steel

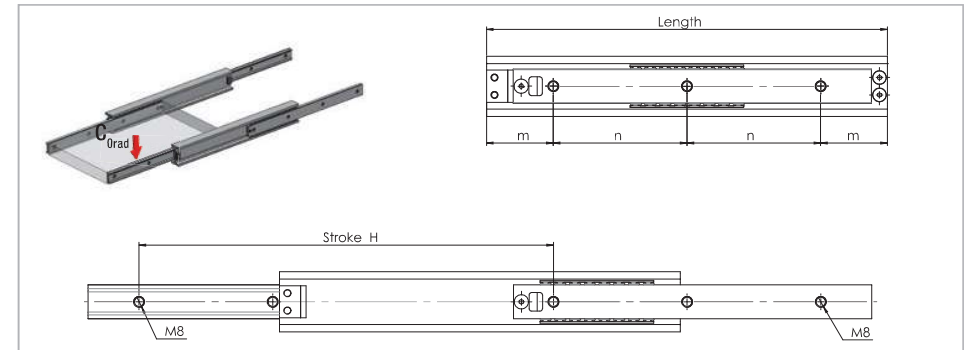
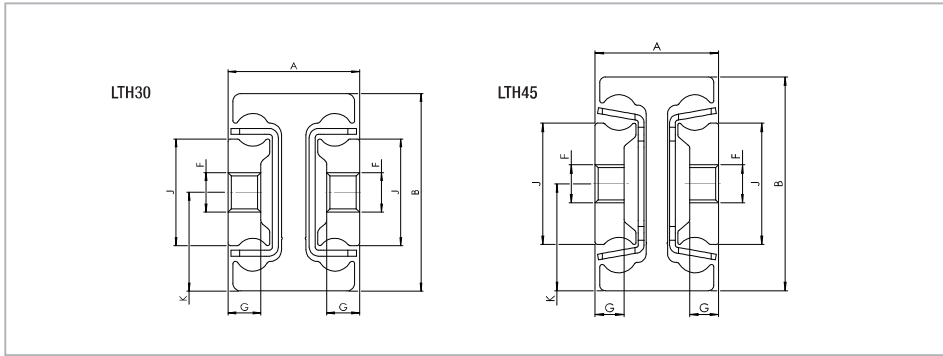

Fig. 51

Type	Size	Length L [mm]	Stroke H [mm]	Load capacity per pair		m [mm]	n [mm]	Number of holes
				C_{Drad} [N]	C_{Dax} [N]			
LTH...S	45	300	310	1316	on request	50	100	3
		350	366	1832		75		
		400	422	1666		50		
		450	456	2154		75		4
		500	512	1972		50		
		550	568	2200		75		5
		600	624	2204		50		
		650	680	2426		75		6
		700	714	2942		50		
		750	770	3084		75		7
		800	826	2860		50		
		850	882	2666		75		8
		900	916	2614		50		
		950	972	2450		75		9
		1000	1028	2306		50		
		1050	1084	2178		75		10
		1100	1118	2144		50		
		1150	1174	2034		75		11
		1200	1230	1934		50		
		1250	1286	1842		75		12
1300	1320	1818	50					
1350	1376	1738	75	13				
1400	1410	1716	50					
1450	1488	1596	75	14				
1500	1522	1578	50					

Tab. 26

> LTH



All dimensions are indicated in mm

Fig. 52

Type	Size	A	B	J	G	K	F	Weight per single guide [kg/m]
LTH	30	20	30	16,2	5,0	15,0	M6	3,5
	45	26	45	25,5	6,1	22,5	M8	6,0

Tab. 27

> LTH Special strokes

Special strokes are defined as deviations from standard stroke. They are each available as multiples of the values in tab. 28. These values are dependent on the spacing of the ballcage.

Type	Size	Stroke modification [mm]
LTH	30	15,4
	45	22

Tab. 28

Each stroke modification influences the load capacities stated in the catalogue. For more information please contact Rollon technical support.

> HGT060, HGT080, HGT100, HGT120, HGT150, HGT200, HGT240

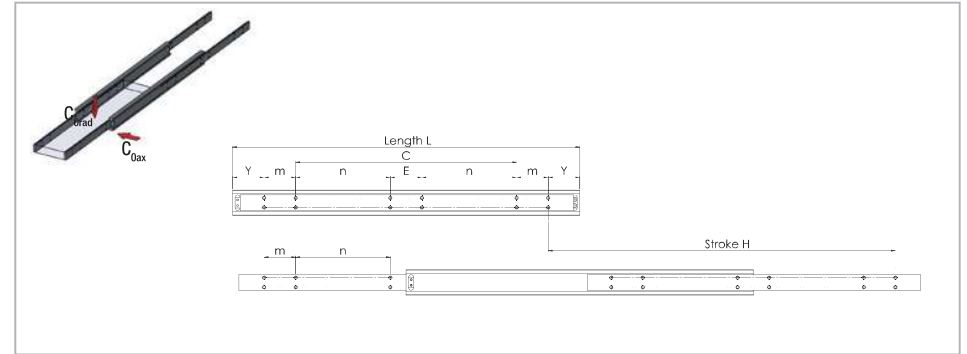

All dimensions are indicated in mm

Fig. 53

Type	Size	Length L [mm]	Stroke H [mm]	Load capacity per pair		Y	m	n	E	C	Number of holes		
				C _{0rad} [N]	C _{0ax} [N]								
HGT	60	400	400	5250	on request	50	50	-	-	200	8		
		450	450	5350						250			
		500	500	5400						300			
		550	550	5500						150	50	-	12
		600	600	5400						175			
		650	650	5350						200			
		700	700	5250						225			
		750	750	5100						250			
		800	800	4900						275			
		850	850	4700						300			
		900	900	4500						325			
		950	950	4300						350			
		1000	1000	4050						375			
		1100	1100	3700						425			
		1200	1200	3300						475			
1300	1300	2900	525										
1400	1400	2500	575										
1500	1500	2100	625										

The load capacity for aluminum is 40% and for stainless steel 60% of the stated values, if available in this material variant (see Technical features overview).

Tab. 29